

M A R A

4275 MISSION BAY DR

FOR LEASE | PACIFIC BEACH, SAN DIEGO, CALIFORNIA



NEW LEASES SIGNED

// LEASING BROCHURE



Pacific Beach

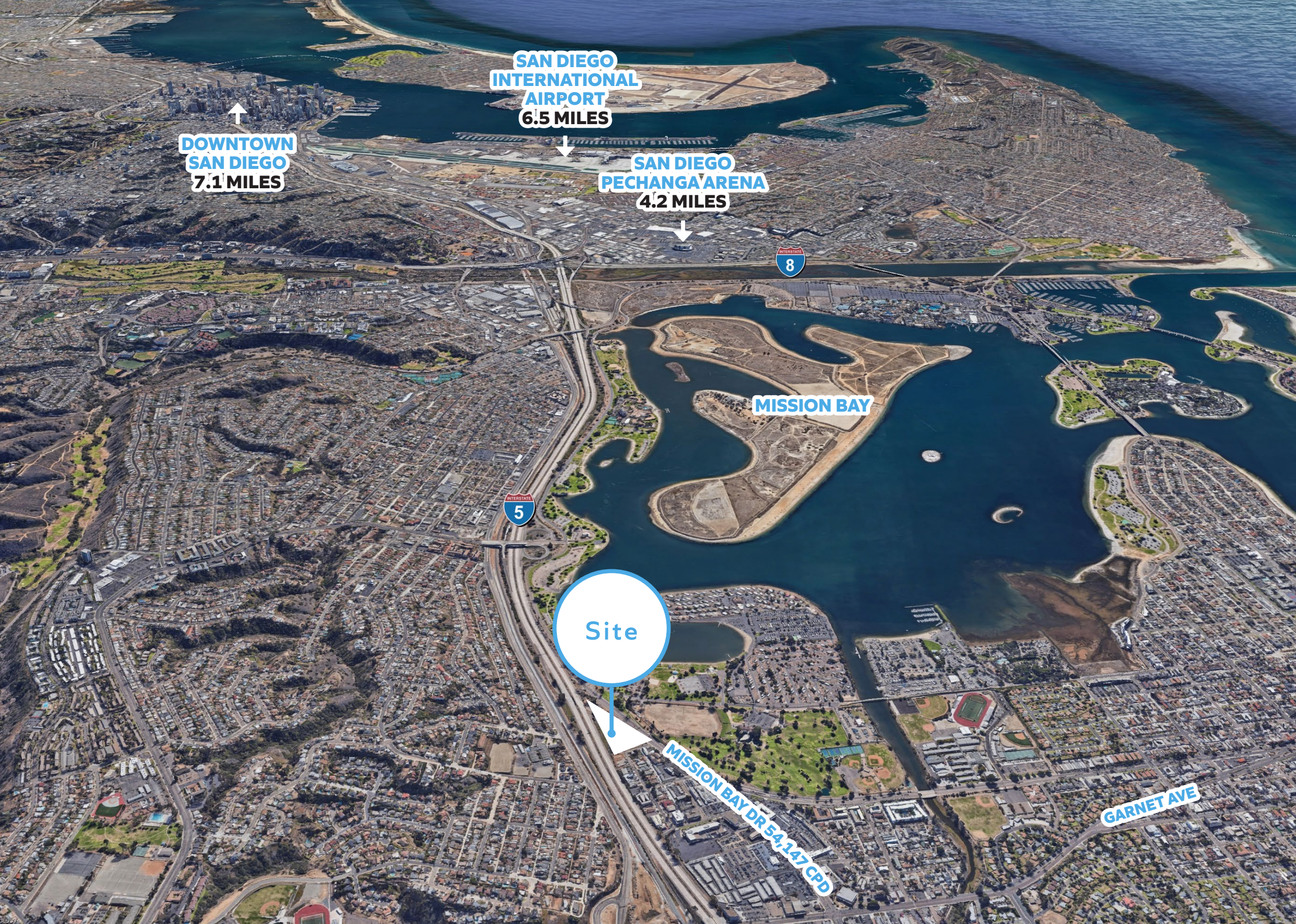

PACIFIC BEACH -

Three miles of boardwalk and year-round festivities makes this coastal community a top destination for both college students and young adults. This neighborhood comes alive at night with the glow of bonfires and the electricity of the area's top-rated patios and bars.

433,058

DAYTIME
POPULATION

275,735

DAYTIME
WORKER
POPULATION

DEMOGRAPHICS
(5 MILES)

POPULATION
358,594

MEDIAN HH INCOME
\$98,309

AVERAGE HH INCOME
\$135,947

MEDIAN DISPOSABLE
INCOME
\$78,616

AVERAGE DISPOSABLE
INCOME
\$96,289

MEDIAN AGE
36.4

155,597

TOTAL
HOUSEHOLDS

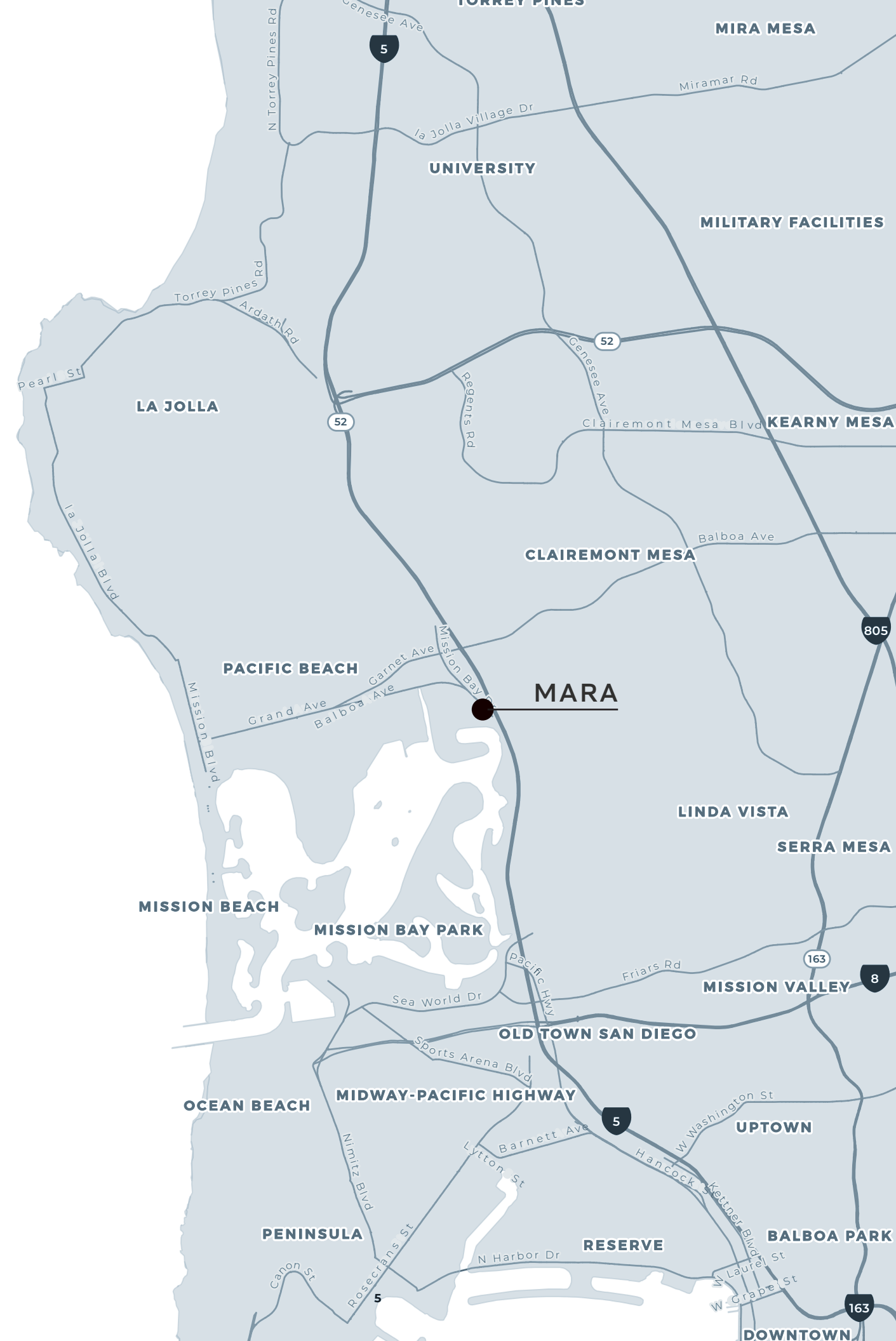

REDEVELOPMENT & REVITALIZATION TO FIT TODAY'S RETAIL LANDSCAPE



Site Plans

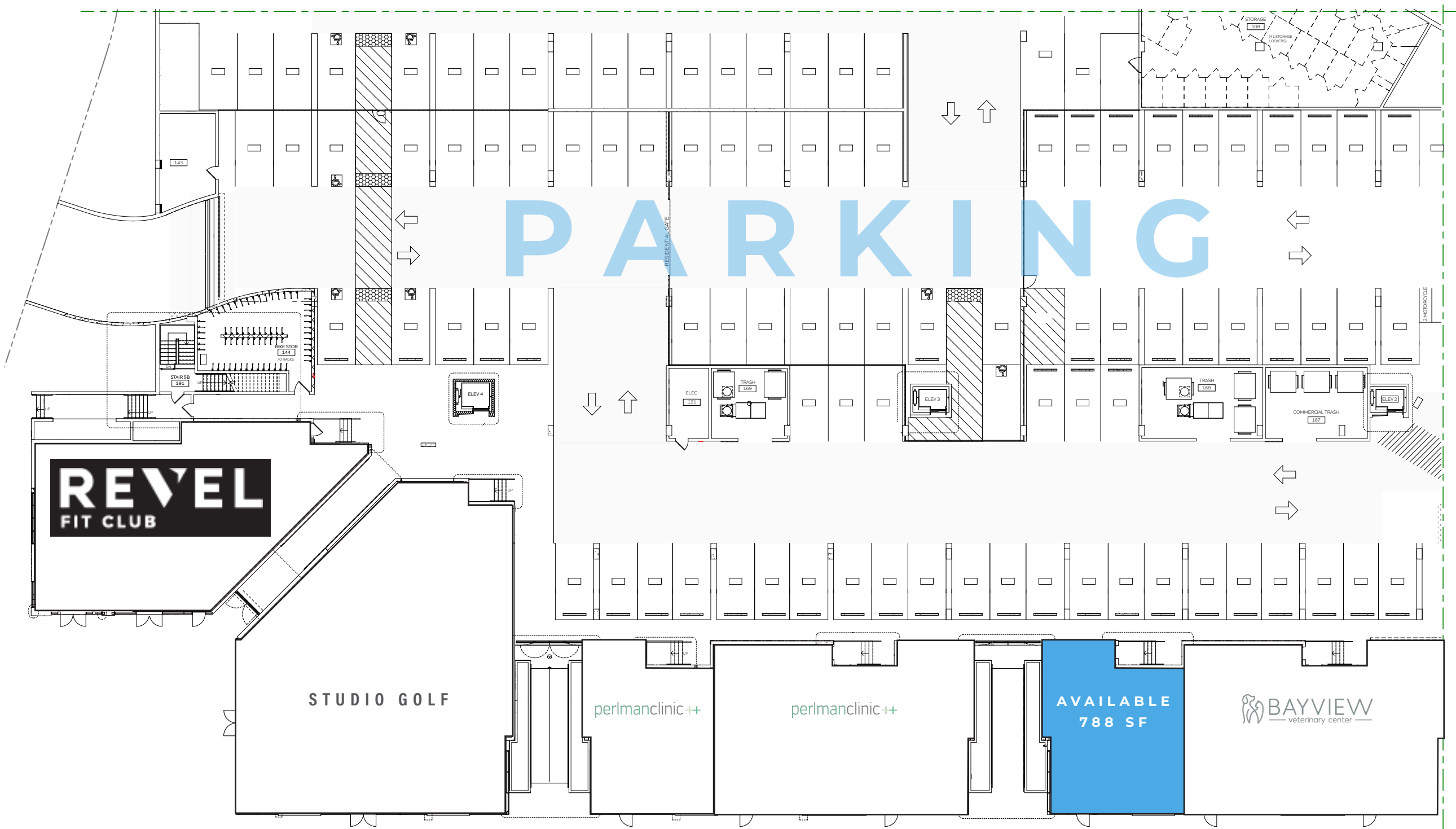

MISSION BAY DR | 54,147 CPD



RUBIO'S COASTAL GRILL



MISSION BAY GOLF COURSE



DE ANZA COVE PARK



REVEL FIT CLUB



SUSHI OTA

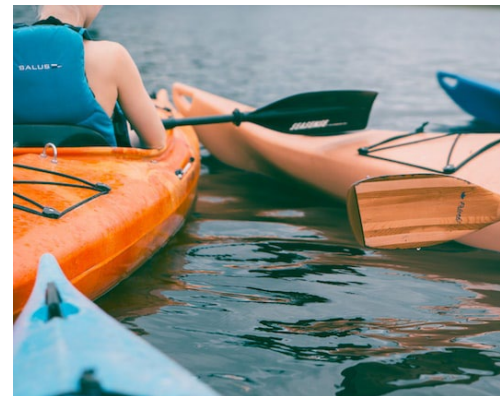

LOCAL KRAVE COFFEE



RI RETAIL INSITE

CONNOR STEVENS

858.369.6458
cstevens@retailinsite.net

JACK AVARELLO

858.257.3484
javarello@retailinsite.net



MARA | 4275 Mission Bay Dr

PACIFIC BEACH, SAN DIEGO, CALIFORNIA

The information above has been obtained from sources believed to be reliable. While we do not doubt its accuracy, we have not verified it and make no guarantee, warranty or representation about it. It is your responsibility to independently confirm its accuracy and completeness. Any projections, opinions, assumptions or estimates used are for example only and do not represent the current or future performance of the property. The value of this transaction to you depends on tax and other factors which should be evaluated by your tax, financial and legal advisors. You and your advisors should conduct a careful, independent investigation of the property to determine to your satisfaction the suitability of the property for your needs.