

1050 S Coast Hwy Oceanside, CA

FOR LEASE. RETAIL SPACE AVAILABLE



Jack Avarello. 858.257.3484 . javarello@retailinsite.net

Brian G. Pyke. 858.324.6103 . bpyke@retailinsite.net

Mark Moser. 858.788.9448 . markmoser@retailinsite.net

Property Features.

- + Approximately 1,281 sf retail space available for lease
- + Monument signage available
- + Retail exposure to Coast Hwy in Oceanside
- + Strong traffic counts of 22,500 CPD on S Coast Hwy
- + Property offers great synergy with neighboring Better Buzz Coffee



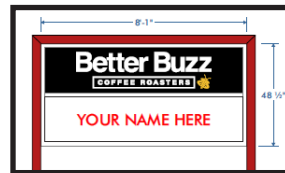
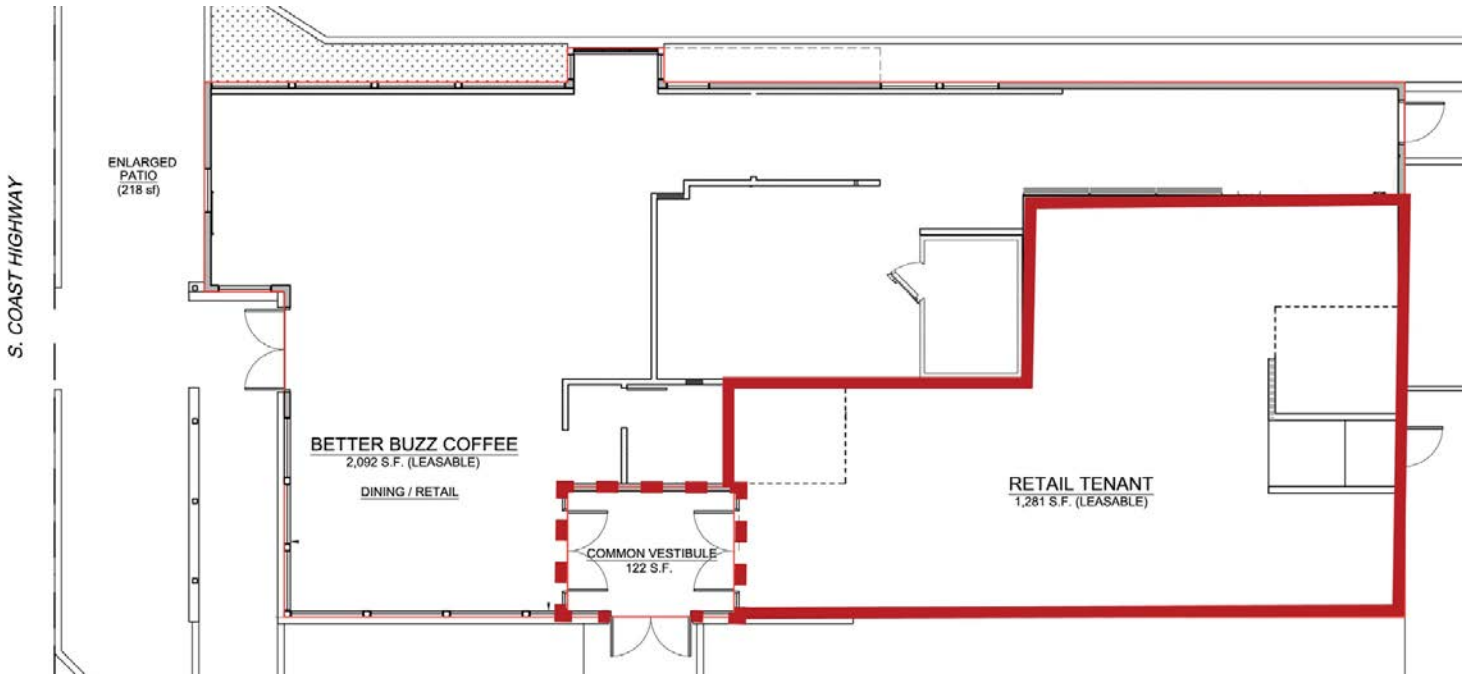

1,281 SF



Oceanside



Available
Mid 2024



Located on PCH
Close proximity
to the I-5 Fwy



The information above has been obtained from sources believed to be reliable. While we do not doubt its accuracy, we have not verified it and make no guarantee, warranty or representation about it. It is your responsibility to independently confirm its accuracy and completeness. Any projections, opinions, assumptions or estimates used are for example only and do not represent the current or future performance of the property.



1050 S Coast Hwy, Oceanside, CA 92024



POPULATION

	1 mile	3 miles	5 miles
Total Population	14,357	68,788	151,718
Projected Population (2028)	14,317	69,720	153,316



HOUSING

	1 mile	3 miles	5 miles
Total Households	6,287	27,823	58,247
Projected Total Households (2028)	6,297	28,378	59,128



INCOME

	1 mile	3 miles	5 miles
Median Household Income	\$74,513	\$77,581	\$83,735
Average Household Income	\$112,049	\$110,042	\$118,536
Per Capita Income	\$49,227	\$44,370	\$45,208
Median Disposable Income	\$61,632	\$62,748	\$68,025
Average Disposable Income	\$81,784	\$81,081	\$86,203



DAYTIME DEMOS

	1 mile	3 miles	5 miles
Total Daytime Population	12,595	68,173	140,227
Daytime Population Workers	6,206	37,093	68,574
Daytime Population Residents	6,389	31,080	71,653



RACE & ETHNICITY

	1 mile	3 miles	5 miles
White	8,085 56.31%	39,077 56.81%	86,208 56.82%
Black or African American	290 2.02%	2,239 3.25%	5,713 3.77%
American Indian & Alaska Native Population	205 1.43%	984 1.43%	2,025 1.33%
Asian Population	478 3.33%	3,050 4.43%	10,084 6.65%
Pacific Islander Population	71 0.49%	557 0.81%	1,382 0.91%
Other Race Population	3,150 21.94%	12,295 17.87%	22,791 15.02%
Population of Two or More Races	2,079 14.48%	10,586 15.39%	23,514 15.50%
Hispanic Population	5,511 38.39%	24,703 35.91%	50,244 33.12%
Non-Hispanic Population	8,846 61.61%	44,085 64.09%	101,474 66.88%



EDUCATION

	1 mile	3 miles	5 miles
Bachelor's Degree	2,584 25.65%	12,973 27.38%	27,890 26.81%
Graduate/Professional Degree	1,513 15.02%	6,504 13.73%	14,488 13.93%



AGE

	1 mile	3 miles	5 miles
Median Age	37.2	35.7	36.3



**1050 S Coast Hwy
Oceanside, CA**

Jack Avarello
858.257.3484
javarello@retailinsite.net

Brian G. Pyke
858.324.6103
bpyke@retailinsite.net

Mark Moser
858.788.9448
markmoser@retailinsite.net

Retail Insite
Commercial Real Estate

405 S. Highway 101, Ste. 150
Solana Beach, CA 92075

lic. 01206760

t. 858 523 2090

w. retailinsite.net